



**GOODRIDGE  
FORWARD**  
OUR STUDENTS, OUR FUTURE

**VOTE ON OR  
BEFORE TUESDAY,  
NOVEMBER**

**07**

# GOODRIDGE PUBLIC SCHOOL BOND REFERENDUM

At our core, Goodridge Public School is committed to our students and their futures. Those futures rely on quality education — something our district is proud to provide. Providing a quality education depends not only on what’s being taught but the environment where it’s taught.

**On Tuesday, November 7, residents of Goodridge Public School will decide whether to invest \$21.35 million into making critical improvements to address our facility and educational needs.**

Visit [GoodridgeForward.org](https://www.GoodridgeForward.org) to learn more about the upcoming referendum.

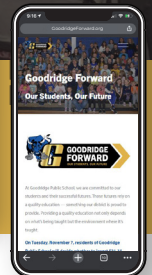

## MESSAGE FROM SUPERINTENDENT LOBERG



"I'm extremely proud to be a Charger. With everything we do, our collective goal is to move **Goodridge Forward** when it comes to education and the spaces where our students learn and grow. Our school board and administration are confident that the proposed plan best positions our district, and our students, for the future."

- **Tomas Loberg, Goodridge Public School Superintendent**

## OUR CHALLENGES

- Many of our building's heating systems are inadequate, outdated, or past their useful life.
- Our school lacks enough restrooms to support our students.
- We lack a dedicated, secure entrance, and our district office is currently located on the second floor — away from the main entrance area.
- We do not have enough space, and we are currently using spaces not originally designed to support students, particularly for Special Education.
- Several classrooms and other areas do not meet the MDE's recommended guidelines for space and educational adequacy.
- Our shop area is undersized and only provides enough space for woodworking.
- Our gyms are undersized and no longer meet our needs for physical education, athletics, and activities.

Visit [GoodridgeForward.org/challenges](https://www.goodridgeforward.org/challenges) for more information on our facility challenges.



## WHAT'S ON THE BALLOT?

On Tuesday, November 7, residents of Goodridge Public School will decide on a single-ballot question to invest \$21.35 million into making critical improvements to address our facility and educational needs.

After evaluating several options, the Goodridge School Board feels that the proposed plan balances critical educational and facility needs well. Ultimately, our community will make this decision.

NOVEMBER

07

## MORE ABOUT THE PLAN

- Expand our educational space to support Career and Technical Education and expose students to various career paths.
- Build a classroom addition to house students in grades 3-6 and provide space to support Special Education and flexible collaboration needs.
- Improve and right-size other educational spaces, including our science classrooms, elementary classrooms, and more.
- Build a full-size gymnasium, including locker rooms, a concessions area, and a new weight room with community access.
- Install a new boiler system, temperature controls, and other system improvements.
- Create a dedicated, secure entrance and relocate the district office near it.
- Build additional restrooms and make additional bathroom improvements.

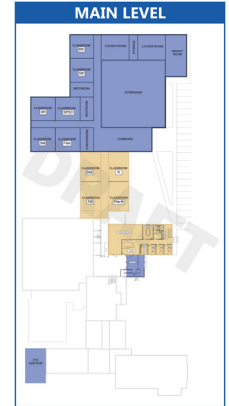

Visit [GoodridgeForward.org/plan](https://GoodridgeForward.org/plan) to view all conceptual drawings.

## THE INVESTMENT OF THE PLAN

If approved, the estimated tax impact on a **\$100,000 residential home in the district would be approximately \$35 per month starting in 2024**. The bonds would be issued for a period of 20 years.

To find your estimated tax impact, visit [GoodridgeForward.org/cost](https://GoodridgeForward.org/cost).



## ATTENTION AGRICULTURAL LANDOWNERS!

The State of Minnesota's Ag2School Tax Credit reduces the tax impact for agricultural landowners when it comes to bond referenda like ours.

**Ag2School is a 70% tax credit provided to all agricultural property except the house, garage, and one acre surrounding the agricultural homestead.**

If you own agricultural property, we encourage you to visit the agricultural property section of the tax calculator, available at [GoodridgeForward.org/cost](https://GoodridgeForward.org/cost). After completing a short form, Ehlers, Inc., the district's financial advisor, will be in contact with you to provide an accurate calculation. If you have any questions, please call Ehlers at 1.800.552.1171.



**MINNESOTA'S AG2SCHOOL TAX CREDIT**

**Ag2School credits would pay for approximately 60% of the project's total debt service payments.**



NON-PROFIT  
ORGANIZATION 35309  
US POSTAGE PAID  
GOODRIDGE,  
MN 56725  
PERMIT NO. 4

**Goodridge Public School**  
201 Osmund Avenue, PO Box 115  
Goodridge, MN 56725



 [GoodridgeForward.org](http://GoodridgeForward.org)    [@goodridgeisd561](https://www.facebook.com/goodridgeisd561)    [@GoodridgeSchool](https://twitter.com/GoodridgeSchool)    218.378.4134

## MAKE YOUR PLAN TO VOTE



### **Vote Early by Mail — Friday, September 22 through Monday, November 6:**

Residents can vote early by mail by either requesting a ballot online or calling their respective county auditor/treasurer's office (Pennington County or Marshall County). If you hand-deliver your ballot to the county auditor/treasurer's office, you must do so by 3:00 p.m. on Election Day. Mailed ballots must be received by 8:00 p.m. on Election Day.



### **Vote Early in Person — Friday, September 22 through Monday, November 6:**

Residents can vote early in person at the Auditor/Treasurer Office in the Government Center (Old Courthouse) in Thief River Falls, Monday through Friday, between 8:00 a.m. and 4:30 p.m., except for holidays. There are extended hours from 9:00 a.m. to 3:00 p.m. on Saturday, November 4, and from 8:00 a.m. to 5:00 p.m. on Monday, November 6.



### **Vote in Person on Election Day — Tuesday, November 7:**

Residents can vote in person on Election Day on Tuesday, November 7, from 7:00 a.m. to 8:00 p.m. at The Goodridge Senior Center, located at 307 Vaughn Main Street East, Goodridge, MN 56725.

Visit [GoodridgeForward.org/vote](http://GoodridgeForward.org/vote) for more information on voting.